

# Saddle installation and adjustment

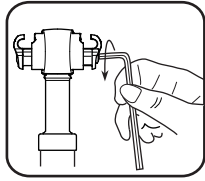

**1**  
Loosen the bolt to open the clamps wider than rails diameter.

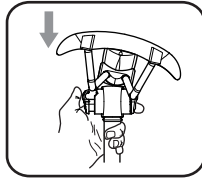

**5**  
Push the other rail into the clamp with click.

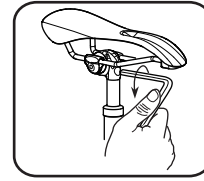

**7**  
Loosen the bolt to get the inner ring clamp movable.

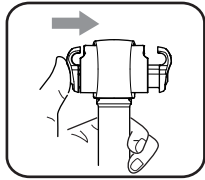

**2**  
Push the clamp to the end of one side and hold it fully open.

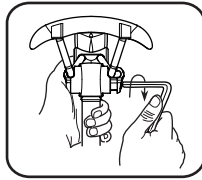

**6**  
Center the side clamps and pre-tighten the bolt to softly hold the rails in the clamps.

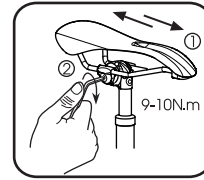

**8**  
Independent saddle rails adjustment: Adjust the rails back and forth and well tighten it with torque range 9-10N.m at the position you like.

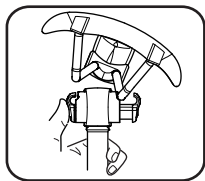

**3**  
First get one side of the rail into the half groove of the clamp. Be noted that clamp head offset must be placed to the back side and in direction with back side of the saddle.

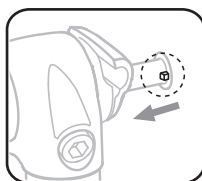

**Attention!**  
Before tighten the screw. Make sure the POINT on the screw is slid into the slot when you tighten the side cap.

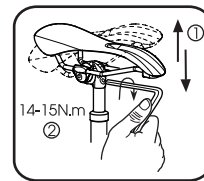

**9**  
Independent saddle angle adjustment: Adjust the saddle angle and well tighten it with torque range 14-15N.m at the angle you like.

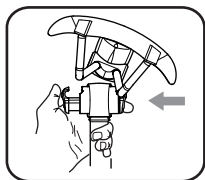

**4**  
Push one side clamp to the end and hold the rail against the other half groove of the clamp.

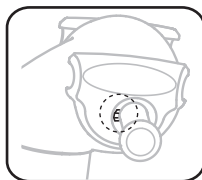

## ELEGANCE-LT USER'S MANUAL

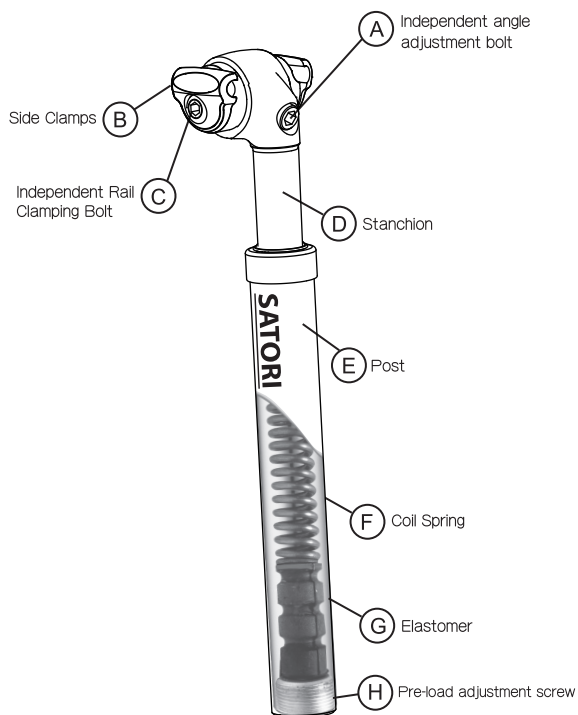

COIL SPRING

## Instructions and attentions

D1411

### 1 Pre-load adjustment:

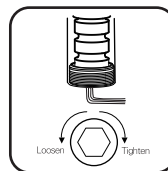

Tighten the pre-load adjustment screw from the bottom with clock-wise or loosen with counterclockwise to adjust its tension.



**Attention!** The treads of the screw can't be seen from outside of the post.

### 2 Attention:

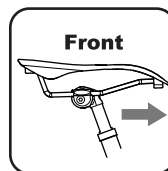

**1** Offset of clamp head must be faced back and in direction with saddle back.

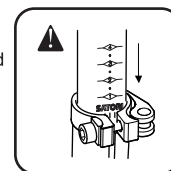

**2** The Min.insertion mark at 100mm must be inside of the seat tube.

### 3 Replacement:

#### Coil spring replacement :

Remove the bottom pre-load nut and take out the spring set.  
Replace the old spring with the new ones and assemble back the parts.  
The pre-load nut must be fully engaged with the seatpost.

#### Weight applications of spring rates :

	Soft	Medium	Hard	Hard+
<b>Spring</b>	(3.2mm) ≤ 65 kgs	(3.5mm) 66~85kgs	(3.8mm) 86~100kgs	(4.0mm) 100~150kgs